

Conference Programme

Tenth International Meeting on Experimental and Behavioural Social Sciences (IMEBESS)

Prague is one of the most beautiful cities in the world. The city is romantic and successful, ancient and modern, but above all it is a city that is cosmopolitan through and through, very used to welcoming visitors. The Prague Congress Centre is one of the largest and best-equipped European centres, the ideal venue for this event. Metro access to the City Centre from the venue is convenient and takes minutes.



IMEBESS Programme Committee

Programme Committee 2026

- Ray Duch (University of Oxford)
- Jordi Brandts (Institute for Economic Analysis, CSIC)
- Diego Gambetta (Collegio Carlo Alberto)
- Laura Fortunato (University of Oxford)
- Edward Asiedu (University of Ghana Business School)
- Enrique Fatas (European University of Valencia)
- Klarita Gërxhani (Vrije Universiteit Amsterdam)
- Wojtek Przepiorka (University of Bern)
- Astrid Hopfensitz (Emlyon Business School)
- Sonja Vogt (University of Lausanne)
- Andris Saulitis (University of Latvia & Collegio Carlo Alberto)

Conference Manager: Mel Sawers melanie.sawers@nuffield.ox.ac.uk



2026 Draft Schedule

Wednesday

IMEBESS 2026 coincides with the 2026 Prague meeting of the European Political Science Association ([EPSA 2026 Prague](#)). A pre-conference [LLM Workshop](#) on **July 8, 2025** will highlight the contributions of Oxford's very successful [Synthetic Replication Games](#) that was inaugurated at IMEBESS 2025 Valencia

Thursday

Registration opens in Prague Congress Centre	from 08:30
Welcome and Keynote 1	09.15 – 11:00
Coffee Break	11:00 – 11.30
Panel Session 1	11.30 – 13.00
Lunch	13.00 – 14:00
Panel Session 2	14.00 – 15.30
Coffee Break	15:30 – 16.00
Panel Session 3	16.00 – 17.30

Friday

Registration opens in Prague Congress Centre	from 09:00
Keynote 2	09.30 – 11:00
Coffee Break	11:00 – 11.30
Panel Session 4	11.30 – 13.00
Lunch	13.00 – 14:00
Panel Session 5	14.00 – 15.30
Coffee Break	15:30 – 16.00
Panel Session 6	16.00 – 17.30
Keynote 3	17.30 – 18.30
Conference Dinner (Event venue)	18.45 - 21:30

Saturday

Registration opens in Prague Congress Centre	from 09:00
Panel Session 7	09.30 – 11:00
Coffee Break	11:00 – 11.30
Panel Session 8	11.30 – 12.30

Conference Venue Location and Directions

The conference will take place at the **Prague Congress Centre**:

5. května 1640/65, Nusle

140 00 Prague 4, Czechia

[How to get to the Prague Congress Centre?](#)



Free Event Internet / Wi-Fi Information

SSID (Network Name): TBC

Password: TBC

Registration and Exhibitors

The registration desk and the exhibitors will be located in the first floor foyer to access please use building entrance Number 4 (Ground Floor) of the Prague Congress Centre



FLOOR PLANS

Plány pater



4TH FLOOR | 4. patro

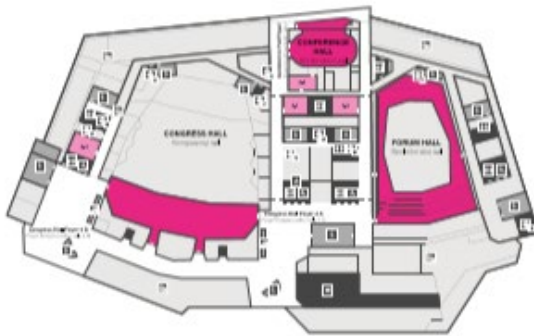

3RD FLOOR | 3. patro

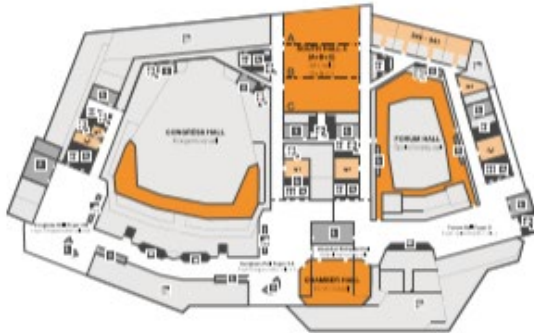

2ND FLOOR | 2. patro



1ST FLOOR | 1. patro



GROUND FLOOR | Půzemí



Accommodation

Recommended Conference Hotel - [Holiday Inn Prague | Hotel Prague](#)

- Located **next to the Prague Congress Centre** ($\approx 2\text{--}3$ min walk)
- 300m from Vyšehrad metro station with direct links to city centre
- Approx. **10–15 minutes to Old Town by metro**
- Comfortable 4★ hotel with restaurant, garden, and business facilities
- Ideal for speakers and attendees wanting maximum convenience

 **Other Nearby Options - [CLOSEST Hotels to Prague Congress Centre](#)**

- **Hotel Coronet** – quiet, good-value hotel (~ 4 min walk)
 - **Residence Vyšehrad** – apartment-style accommodation (~ 3 min walk)
 - **Hotel Union Prague** – well connected via tram ($\sim 5\text{--}7$ min)
 - **Hermitage Hotel Prague** – higher-end option (~ 10 min)
-

Explore Prague



Prague is one of Europe's most beautiful and accessible cities, offering a mix of historic architecture and vibrant cultural life.

[Top Tourists Attractions, Landmarks in Prague, Czech Republic](#)

- Charles Bridge & Prague Castle
- Old Town Square & Astronomical Clock
- Vltava riverfront walks and cafés
- Vyšehrad park (next to the venue)

 July weather: warm and pleasant ($\approx 22\text{--}28^\circ\text{C}$)